

Madison, Wisconsin

INDEX OF SHEETS

SHEET NO.	NOTES AND DETAILS
D1-D3	NOTES AND DETAILS
P1	STREET PLAN & PROFILES
U1	UTILITY PLAN & PROFILES
U2	STORM SEWER SCHEDULE
E1-E3	ELECTRICAL PLANS
PM1	PAVEMENT MARKING PLANS
MN1	MAINTENANCE MAP

CITY OF MADISON

CITY ENGINEERING DIVISION

DEPARTMENT OF PUBLIC WORKS

PLAN OF PROPOSED IMPROVEMENT

W MAIN ST BIKE BOULEVARD

(FEDERALLY FUNDED)

CITY PROJECT NO. 13015

CONTRACT NO. 8721

WISDOT CONSTRUCTION ID 5992-00-66

PROJECT LOCATION

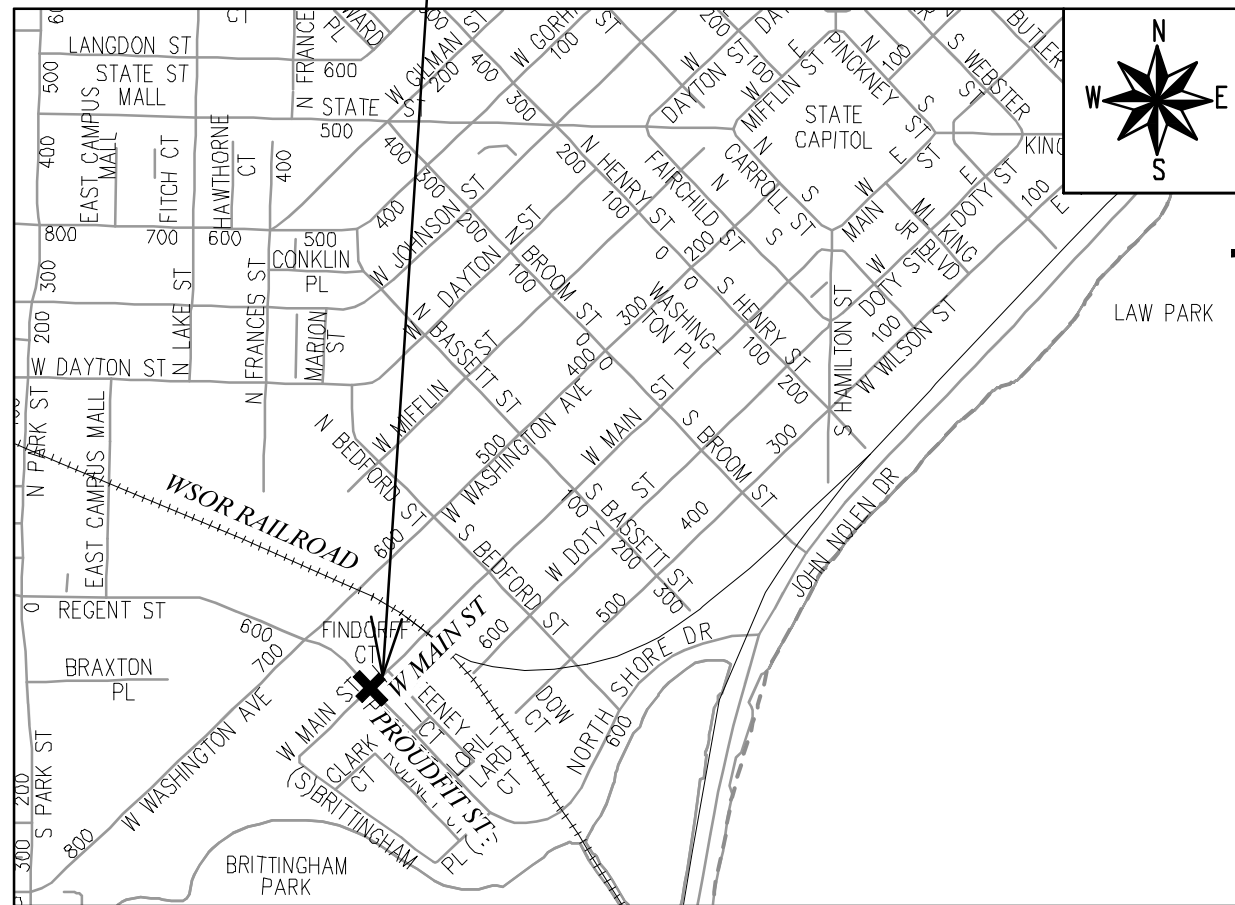

CONVENTIONAL SIGNS	
FIELD VERIFY ALL UTILITY LOCATIONS	
GAS	— G —
STORM SEWER	— ST —
SANITARY SEWER	— SAN —
WATER	— W —
BURIED ELECTRIC	— E —
OVERHEAD ELECTRIC	— OH —
POWER POLE	
ADA COMPLIANT RAMP W/ DETECTABLE WARNING FIELD	
COMBUSTIBLE FLUIDS	

NOTES:

ALL GUTTERS SHALL DRAIN WITH A MINIMUM GRADE OF 0.50% TOWARD STORM SEWER INLETS.

SIDEWALK RAMPS SHALL HAVE A MAXIMUM SLOPE OF 1" PER 12". SIDEWALK AND CURB RAMPS SHALL BE CONSTRUCTED WITH A SIDE SLOPE OF 2.00%. SIDEWALK SHALL HAVE A MINIMUM LONGITUDINAL SLOPE OF 0.50% AND A MAXIMUM LONGITUDINAL SLOPE OF 5.00% EXCEPT WHERE STREET GRADES EXCEED 5.00%.

EARTHWORK SUMMARY:

EXCAVATION CUT (MEASURED PLAN QUANTITY).....	120 CY
ESTIMATED UNDISTRIBUTED UNDERCUT.....	10 CY
TOTAL UNCLASSIFIED EXCAVATION CUT.....	130 CY

PUBLIC IMPROVEMENT PROJECT APPROVED

SEPTEMBER 6, 2022

BY THE COMMON COUNCIL OF MADISON, WISCONSIN

PUBLIC IMPROVEMENT DESIGN APPROVED BY:

Mar 28, 2023

City Engineer Date

STREET DESIGNED BY:

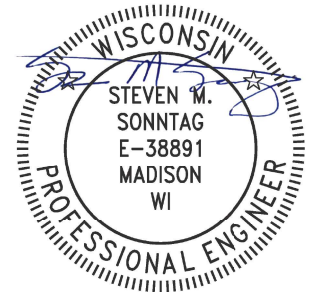

Mar 29, 2023

STORM SEWER DESIGNED BY:



Mar 28, 2023

STREET GEOMETRICS & PAVEMENT MARKINGS DESIGNED BY:

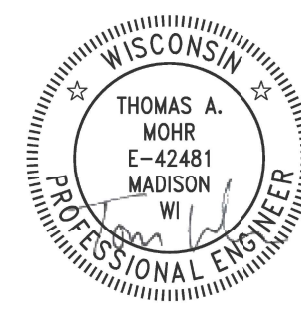

Mar 28, 2023

ELECTRICAL DESIGNED BY:

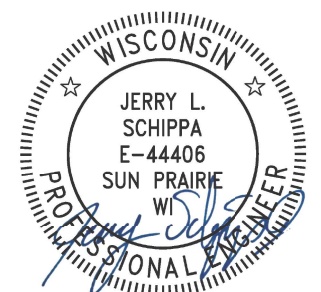

Mar 28, 2023

PLOT SCALE: 1 IN = 1 F_XREF

PLOT NAME: ---

REV. DATE: 3/3/2023 3:48 PM

ORIGINATOR: CITY OF MADISON

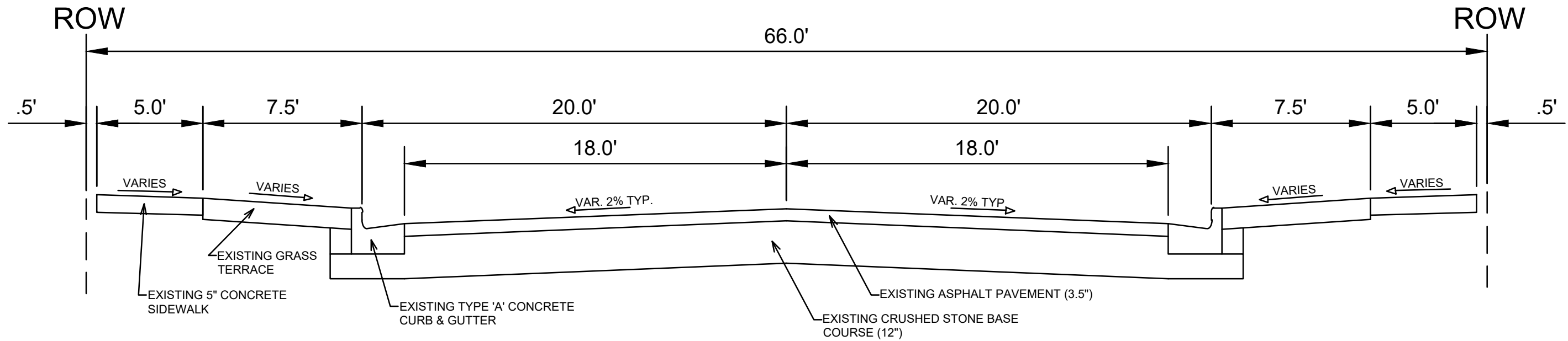

EXISTING TYPICAL SECTION
W MAIN ST
(PROUDFIT ST)

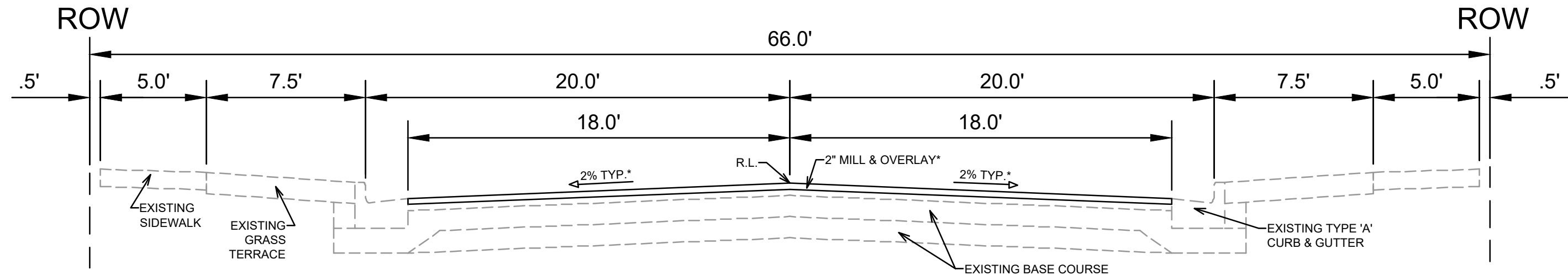

FINISHED TYPICAL SECTION
W MAIN ST
(PROUDFIT ST)

MARK	REVISION	DATE	BY
13015		3/2/2023	1:02 PM
Designated By: AJC	Scale: #####		
13015			D-1

13015
 MADISON, WI
 CONTRACT NO: 8721

EXISTING TYPICAL SECTIONS
 W MAIN ST BIKE BOULEVARD
 M:\DESIGN\Projects\13015\CAD\Streets\13015EN-Details.dwg



WESTERLY MEDIAN ISLAND REFUGE

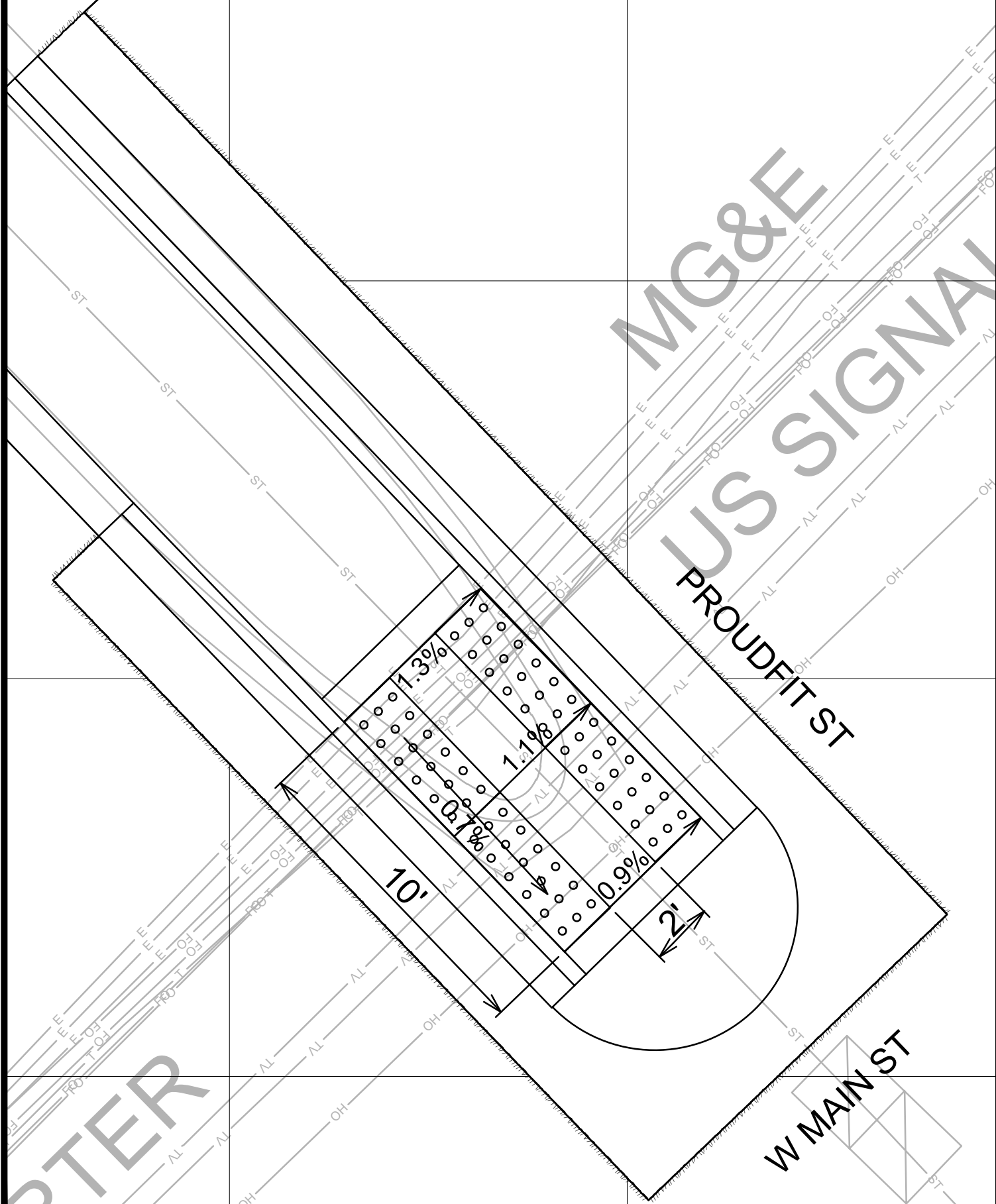

EASTERLY MEDIAN ISLAND REFUGE

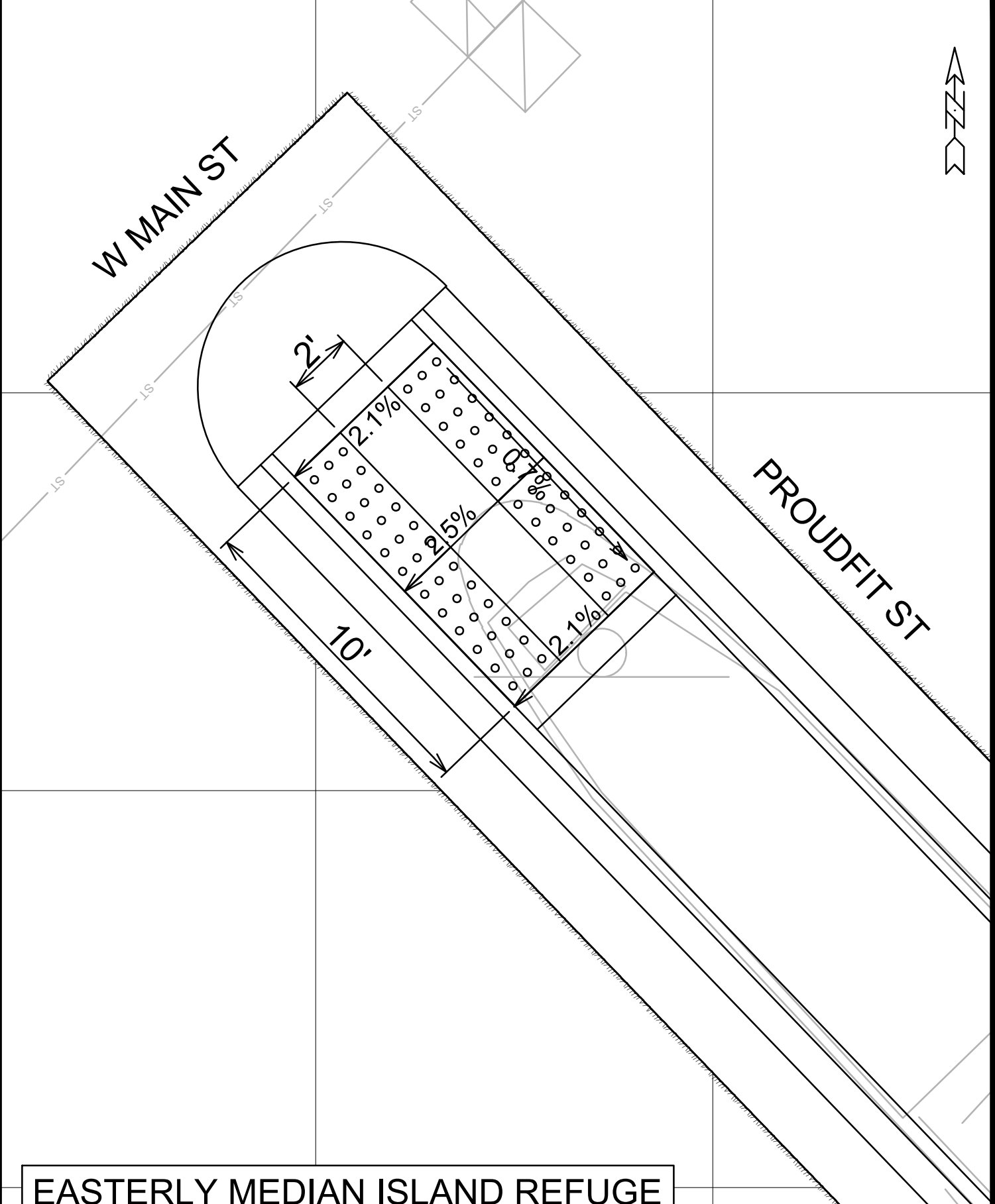

MARK	REVISION	DATE	BY
Designated By: AJC	Date: 3/2/2023 12:57 PM	Scale: #####	D-2

13015
MADISON, WI
CONTRACT NO: 8721

CURB RAMP DETAILS
W MAIN ST BIKE BOULEVARD
M:\DESIGN\Projects\13015\CAD\Streets\13015EN-PnP.dwg



13015
D-2

WEST CURB RAMPS

- STA 14+90.93, 42.46' LT
858.28 FW/MATCH
- STA 14+85.75, 42.49' LT
858.23 BW/MATCH
- STA 14+90.95, 32.75' LT
858.05 FW/RAMP
- STA 14+85.77, 32.12' LT
857.93 BW/KEY
- STA 14+90.67, 26.73' LT
857.92 FW/RAMP
- STA 14+80.83, 32.12' LT
857.90 BW/MATCH
- STA 14+85.62, 26.97' LT
857.86 FW/RAMP
- STA 14+80.62, 26.87' LT
857.81 FW/MATCH

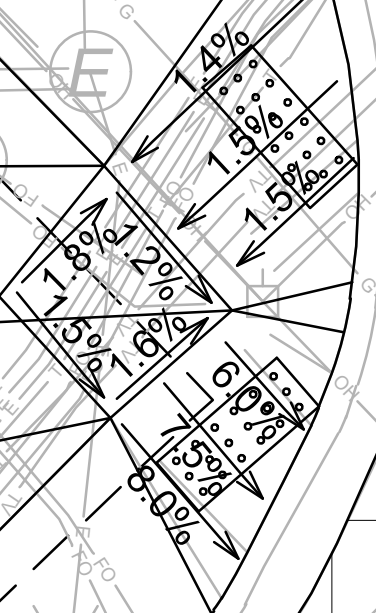

PROUDFIT ST

W MAIN ST

NORTH CURB RAMPS

- STA 15+94.51, 31.91' LT
858.52 BW/KEY
- STA 15+94.80, 36.91' LT
858.57 BW/MATCH
- STA 15+89.29, 32.04' LT
858.39 FW/RAMP
- STA 15+89.61, 37.23' LT
858.49 FW/MATCH
- STA 15+88.99, 26.93' LT
858.32 FW/RAMP
- STA 15+99.51, 31.88' LT
858.65 BW/MATCH
- STA 15+94.38, 26.81' LT
858.40 FW/RAMP
- STA 15+99.37, 26.67' LT
858.54 FW/MATCH



PROUDFIT ST

W MAIN ST

W MAIN ST

PROUDFIT ST

- STA 14+80.75, 26.90' RT
857.99 FW/MATCH
- STA 14+85.75, 26.90' RT
857.97 FW/RAMP
- STA 14+80.55, 32.05' RT
858.20 BW/MATCH

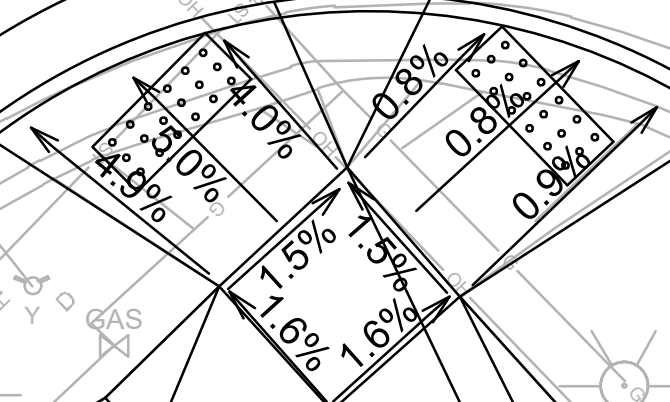

- STA 14+90.75, 37.35' RT
858.05 FW/MATCH
- STA 14+90.90, 32.35' RT
857.98 FW/RAMP
- STA 14+91.21, 27.00' RT
857.93 FW/RAMP
- STA 14+85.51, 37.11' RT
858.15 BW/MATCH
- STA 14+85.55, 32.10' RT
858.14 BW/KEY

SOUTH CURB RAMPS

W MAIN ST

PROUDFIT ST

- STA 15+99.99, 27.49' RT
858.37 FW/MATCH
- STA 15+94.98, 27.54' RT
858.19 FW/RAMP
- STA 16+00.06, 32.90' RT
858.57 BW/MATCH
- STA 15+88.73, 27.30' RT
858.20 FW/RAMP
- STA 15+93.90, 32.98' RT
858.38 BW/KEY
- STA 15+88.68, 32.84' RT
858.22 FW/RAMP
- STA 15+93.86, 37.98' RT
858.49 BW/MATCH
- STA 15+88.64, 37.95' RT
858.36 FW/MATCH

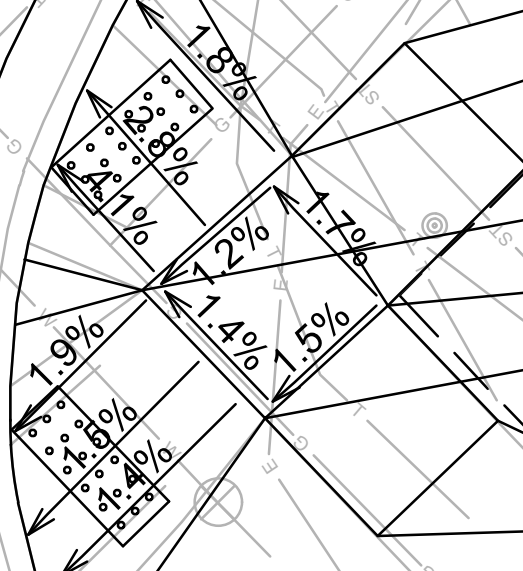

EAST CURB RAMPS

DATE	BY
REVISION	
MARK	
Design: AUC	Date: 3/2/2023 12:57 PM
Scale: #####	
13015	D-3

13015
MADISON, WI
CONTRACT NO: 8721

CURB RAMP DETAILS
W MAIN ST BIKE BOULEVARD
M:\DESIGN\Projects\13015\CAD\Streets\13015EN-PnP.dwg

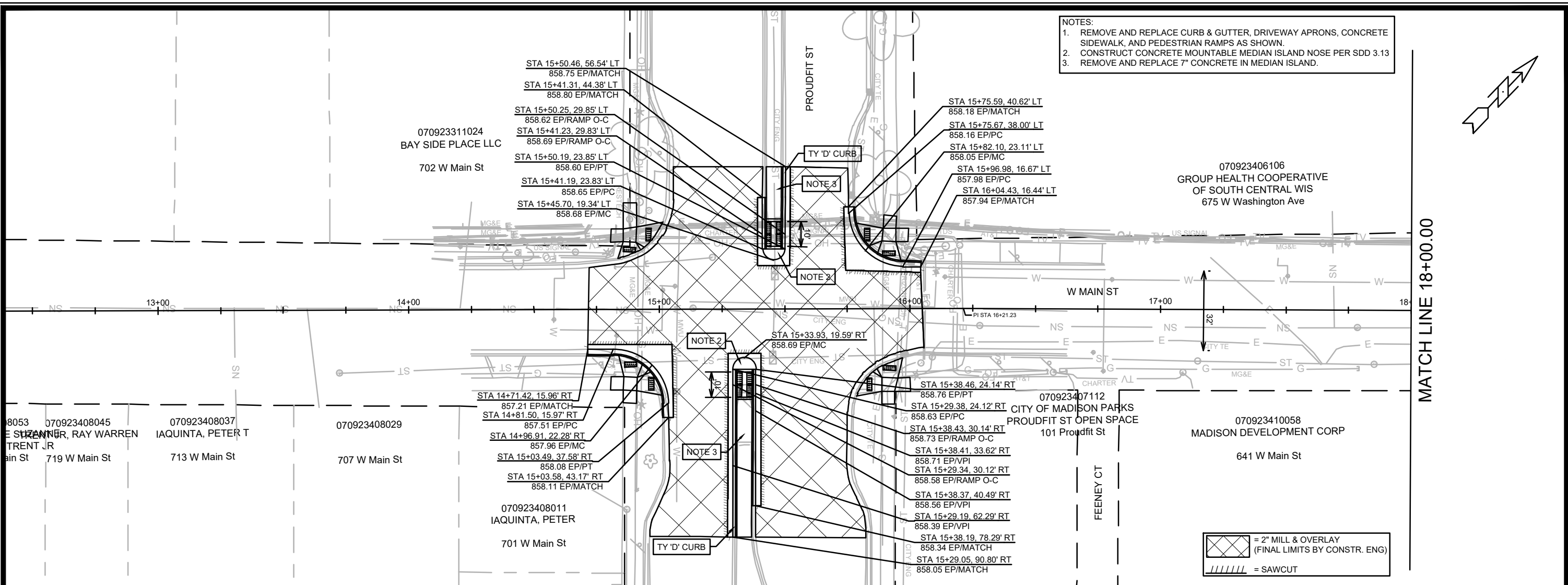

- NOTES:
1. REMOVE AND REPLACE CURB & GUTTER, DRIVEWAY APRONS, CONCRETE SIDEWALK, AND PEDESTRIAN RAMPS AS SHOWN.
 2. CONSTRUCT CONCRETE MOUNTABLE MEDIAN ISLAND NOSE PER SDD 3.13
 3. REMOVE AND REPLACE 7" CONCRETE IN MEDIAN ISLAND.

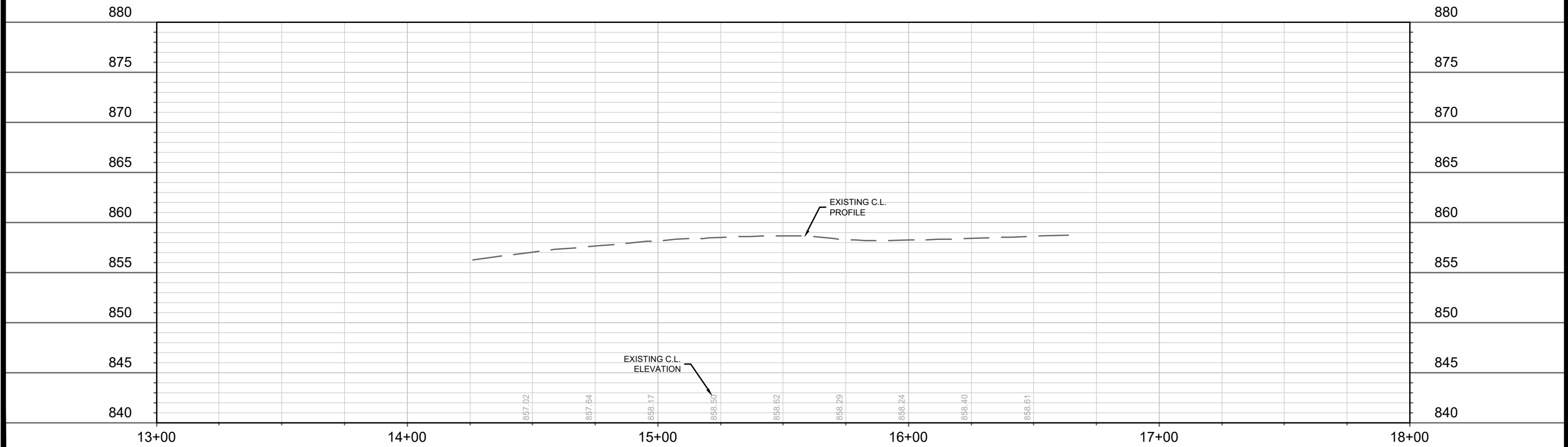
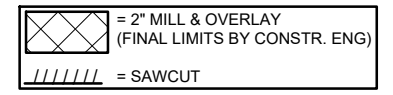

DATE	BY	SCALE	P-1
REVISION			
MARK			
Designated By: AUC	Date: 3/2/2023 12:55 PM	Scale: #####	
13015			
13015	MADISON, WI	8721	CONTRACT NO:
W MAIN ST - PLAN & PROFILE			
W MAIN ST BIKE BOULEVARD			
M:\DESIGN\Projects\13015\CAD\Streets\13015EN-PnP.dwg			
			
13015			
P-1			

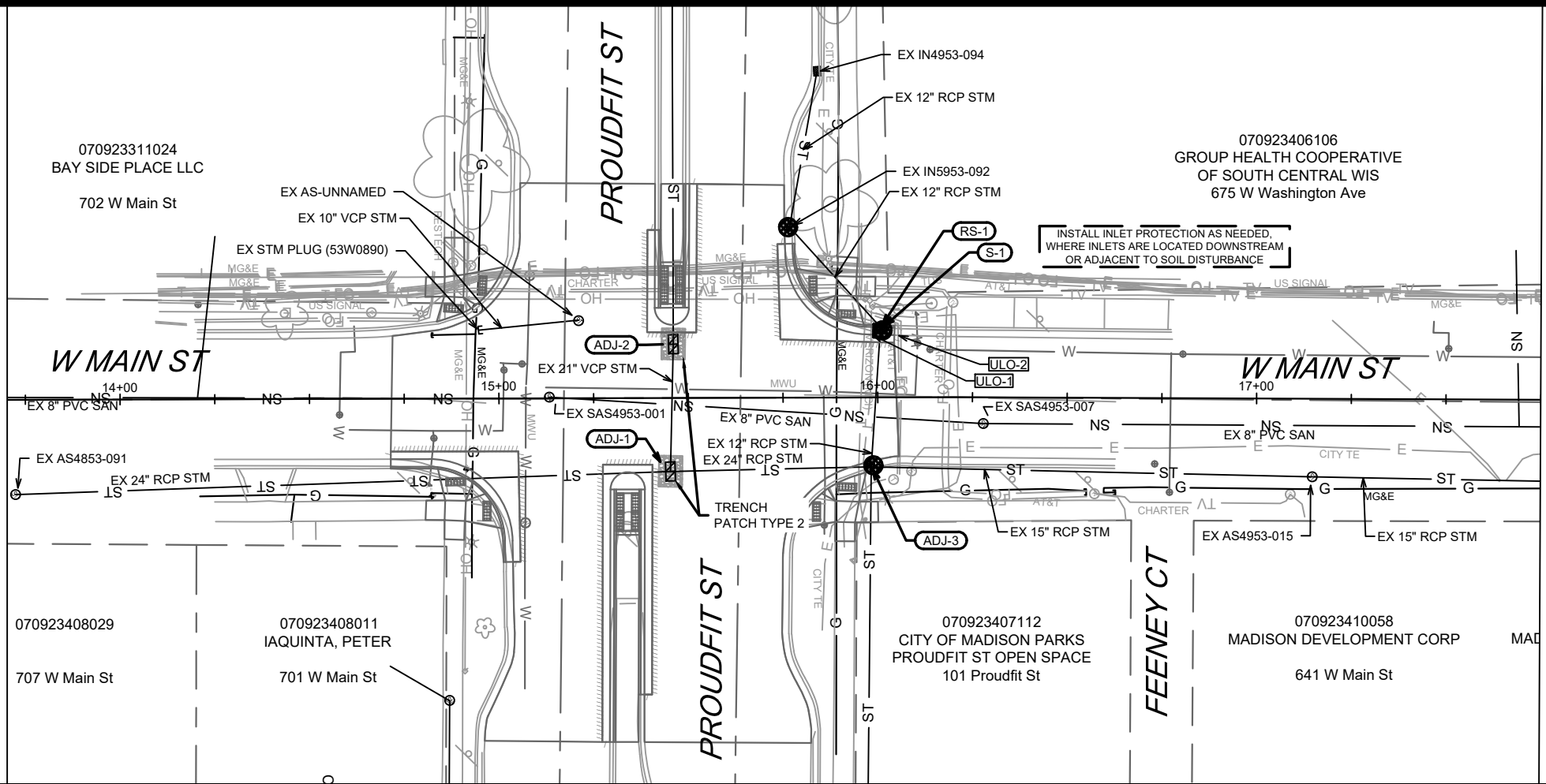

MATCH LINE 17+75.00

EROSION CONTROL NOTES:

EROSION CONTROL MEASURES SHALL BE IN PLACE PRIOR TO ANY OTHER CONSTRUCTION ACTIVITY.

THE CONTRACTOR IS RESPONSIBLE FOR THE CONSTRUCTION AND MAINTENANCE OF ALL EROSION CONTROL MEASURES UNTIL FINAL ACCEPTANCE BY THE CITY OF MADISON.

THE CONTRACTOR SHALL INSTALL AND MAINTAIN EROSION CONTROL MEASURES IN ACCORDANCE WITH TEH WDNR SOC STANDARDS AND CITY OF MADISON STANDARD SPECIFICATIONS.

THE CONTRACTOR SHALL PROVIDE STREET CLEANING AS NEEDED ON A DAILY BASIS TO KEEP TRACKING TO A MINIMUM.

INLET PROTECTION SHALL BE INSTALLED WITHIN THE CONSTRUCTION LIMITS. ADDITIONAL INLET PROTECTION SHALL BE INSTALLED AS DIRECTED.

POLYMER SHALL BE APPLIED TO DISTURBED AREAS AS DIRECTED BY THE CONSTRUCTION ENGINEER.

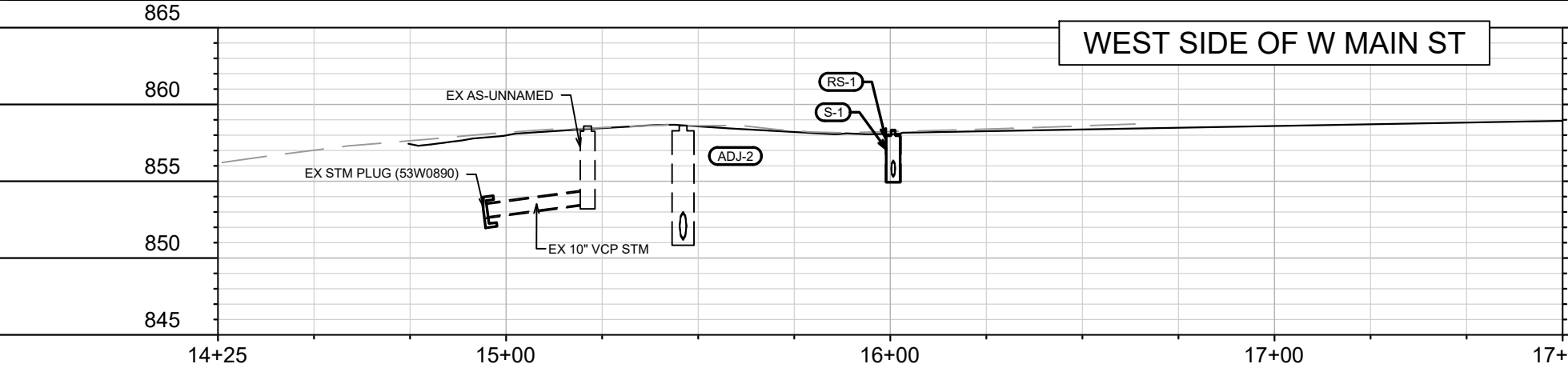

STONE TRACKOUT CONTROL - AS NEEDED (STREET ENTRANCE BERM IS OK)

RIGID FRAME INLET PROTECTION (TYPICAL, FOR ALL INLETS ADJACENT TO ACTIVE DISTURBANCE)

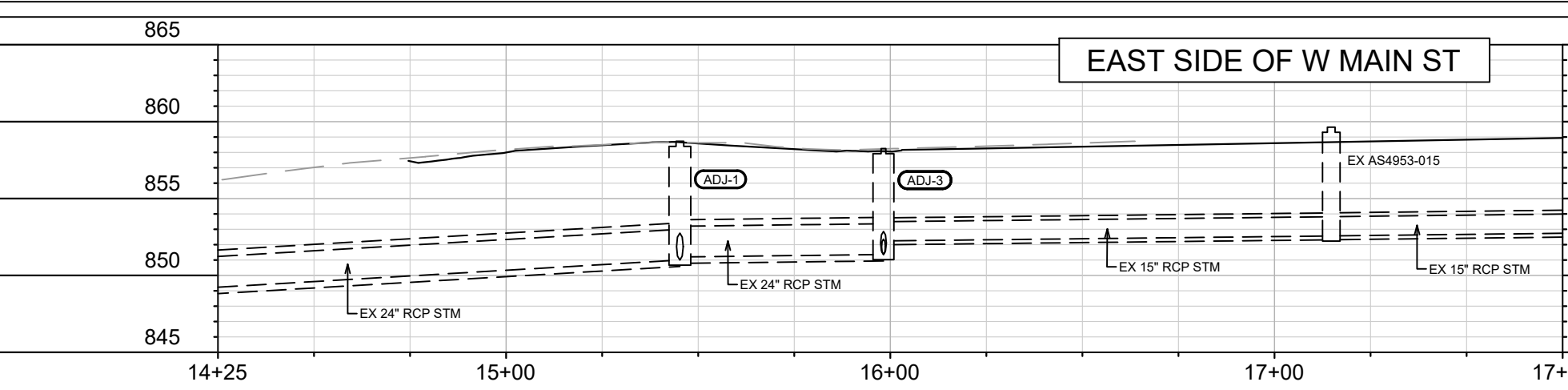

MARK	REVISION	DATE	BY
13015		3/2/2023 3:38 PM	U-1

13015
 MADISON, WI
 8721
 CONTRACT NO:
 W MAIN ST - SEWER PLAN & PROFILE & EROSION CONTROL
 W MAIN ST BIKE BOULEVARD
 M:\DESIGN\Projects\13015\CAD\Sewers\13015SWR-PfP.dwg



13015
 U-1

STORM SEWER SCHEDULE

W MAIN ST BIKE BOULEVARD PROJECT NO. 13015	SHEET NO. U-2	U-2
STORM SEWER SCHEDULE		
CITY OF MADISON		

PROPOSED STORM STRUCTURES

STRUC. NO.	STATION	LOCATION (OFFSET)	TYPE	TOP OF CASTING	E.I.	DEPTH	NOTES
W MAIN ST							
S-1	16+00.75	LT-18.06	3'X3' STORM SAS	858.34	855.27	3.07	FP; W/SALVAGED CASTING

STORM STRUCTURE REMOVALS

STRUC. NO.	ID NO.	STATION	LOCATION (OFFSET)	TYPE	DEPTH (FT)	NOTES
W MAIN ST						
RS-1	IN4953-010	16+00.77	LT-18.56	INLET	2.99	SALVAGE CASTING

STORM STRUCTURE ADJUSTMENTS

STRUC. NO.	ID NO.	STATION	LOCATION (OFFSET)	TYPE	EX TOC	PROP TOC	RIM ADJ (FT)	NOTES
W MAIN ST								
ADJ-1	AS4953-001	15+45.23	RT-19.41	5'X7' CATCHBASIN	858.72	858.62	-0.10	[1]
ADJ-2	AS4953-009	15+46.06	LT-14.20	5'X7' CATCHBASIN	858.62	858.67	0.05	[1]
ADJ-3	IN4953-055	15+98.22	RT-18.33	4'X4' SAS-INLET	858.25	858.56	0.31	[2]; W/SALVAGED CASTING

ULO SCHEDULE

ID NO. (OFFSET)	STATION	LOCATION (OFFSET)	TYPE	NOTES
W MAIN ST				
ULO-1	15+98.30	LT-16.63	FO	
ULO-2	16+05.15	LT-16.47	FO	

SPECIFIC NOTES:

- [1] REPLACE ROOF & CASTING PER BID ITEM 90030; REPLACE CASTING WITH TWO R-1550-0054 CASTINGS
 [2] PAID AS BID ITEM 20501

STANDARD NOTES:

-PLAN LENGTH (PAY LENGTH) IS FROM CENTER OF STRUCTURE TO CENTER OF STRUCTURE. PIPE LENGTH IS ACTUAL LENGTH OF PIPE FROM STRUCTURE WALL TO STRUCTURE WALL. SLOPE CALCULATED USING PIPE LENGTH.

-ALL FIELD POURED SAS STORM STRUCTURES SHALL BE CONSTRUCTED IN ACCORDANCE WITH STANDARD DETAIL DRAWING 5.7.3. ALL PRECAST SAS STORM STRUCTURES SHALL BE CONSTRUCTED IN ACCORDANCE WITH STANDARD DETAIL DRAWING 5.7.5.

-ALL REBAR FOR FIELD POURED STRUCTURES SHALL BE EPOXY COATED. ANY EXPOSED STEEL SHALL BE TOUCHED UP OR RECOATE

- ABBREVIATIONS: AE = APRON ENDWALL; RCP = REINFORCED CONCRETE PIPE; HERCP = HORIZONTAL ELLIPTICAL REINFORCED CONCRETE PIPE; DNA = DOES NOT APPLY; SAS = SEWER ACCESS STRUCTURE; LP = LOW POINT INLET STRUCTURE; FP = FIELD POURED STRUCTURE; TR = TOP OF CONCRETE ROOF; NCM = NO CROWN MATCH FOR PIPES; UD = UNDERDRAIN

- APPROXIMATE DISCHARGE E.I. GIVEN, ADJUST E.I. AND PIPE SLOPE IN THE FIELD.

- TOP OF CASTING GRADE GIVEN IS THE TOP OF CURB FOR INLET STRUCTURES AND THE FLOWLINE OF THE CLOSED CASTING FOR SAS's.

- ALL REINFORCED CONCRETE PIPES TO BE CLASS III UNLESS OTHERWISE NOTED.

- SURVEYOR TO CONFIRM THAT ALL INLET STATION / OFFSETS LINE UP WITH PROPOSED CURB AND GUTTER.

- ALL STRUCTURES CALLED OUT AS FIELD POURED SHALL BE FIELD POURED. ALL OTHER STRUCTURES (NOT INDICATED AS FIELD POURED) SHALL BE SUBMITTED TO CITY ENGINEERING FOR APPROVAL IF PRECAST STRUCTURES ARE PREFERRED. CONTACT DANIEL OLIVARES OF CITY ENGINEERING AT (608) 261-9285 OR DAOLIVARES@CITYOFMADISON.COM. FOR PRECAST APPROVALS EMAIL SHOP DRAWINGS TO DAOLIVARES@CITYOFMADISON.COM.

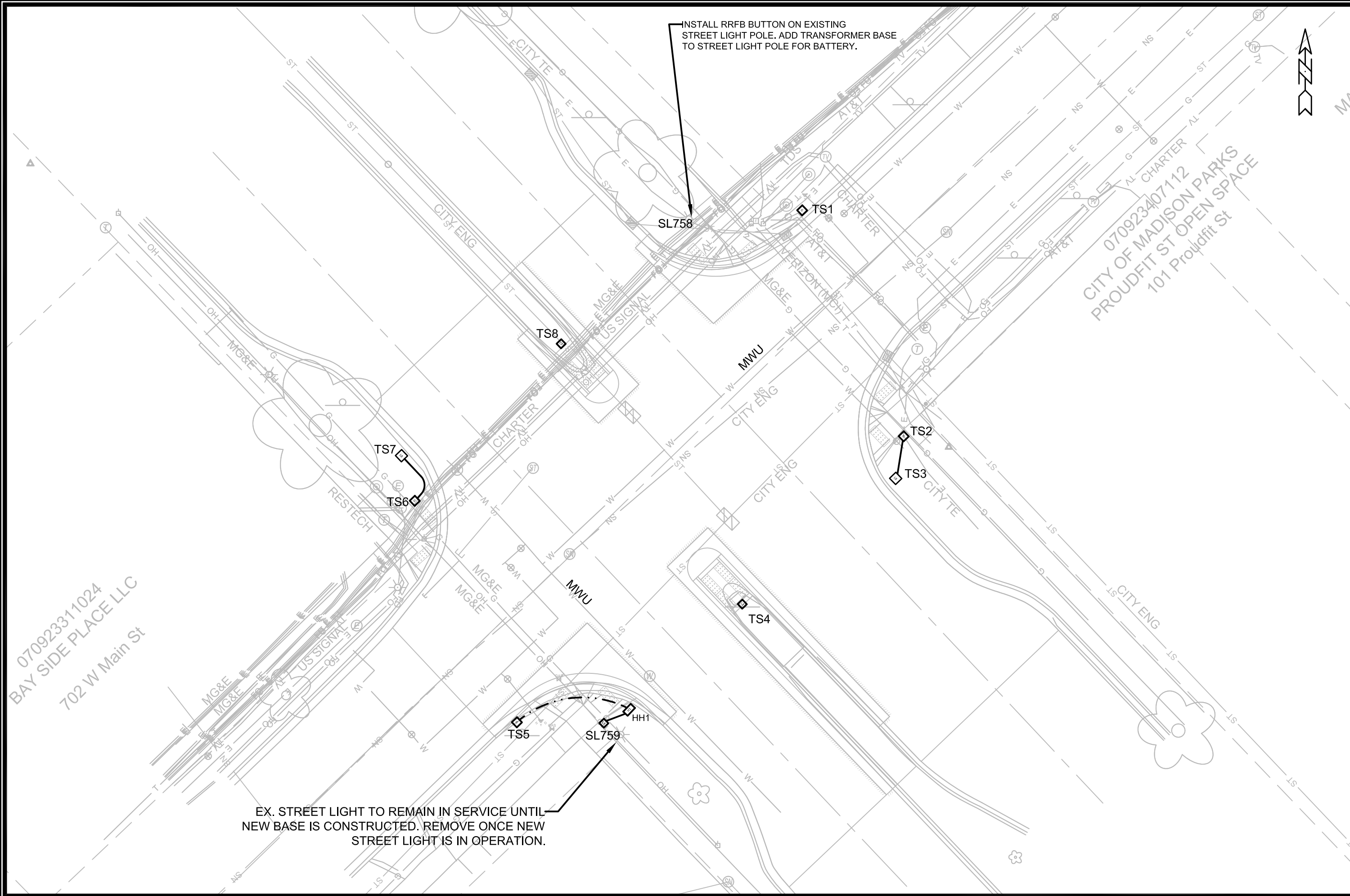

070923311024
BAY SIDE PLACE LLC
702 W Main St

070923407112
CITY OF MADISON PARKS
PROUDFIT ST OPEN SPACE
101 Proudfit St

ELECTRICAL PLANS		13015	E-2
WEST MAIN STREET TAP		MADISON, WI	
M:\DESIGN\Projects\13015\CAD\Traffic\13015TE-Electrical_JLS.dwg		CONTRACT NO: 8721	
CITY OF MADISON WISCONSIN		13015	
13015			
E-2			

Notes: All dimensions are to center of marking and face of curb.
For layout questions, contact Ali Heinritz, aheinritz@cityofmadison.com, 608-267-1102

Callout	Description
1	Pavement Marking Epoxy, Line, 6-Inch
2	Pavement Marking Epoxy, Line, 8-Inch
3	Pavement Marking Epoxy, Crosswalk, 6-Inch
4	Pavement Marking Epoxy, 6-Inch Yellow Skips, (10' Line, 30' Gap)
5	Pavement Marking Epoxy, 6-Inch White Skips, (5' Line, 5' Gap)
6	Pavement Marking Epoxy, Continental Crosswalk, 18-Inch
7	Pavement Marking Epoxy, Stop Line, 24-Inch
8	Pavement Marking Epoxy, Symbol, Bike
9	Green High Friction MMA Pavement Marking
10	Pavement Marking Epoxy, Yellow Curb

* All green crossings to be preformed thermoplastic for the green and white in the bike crossings

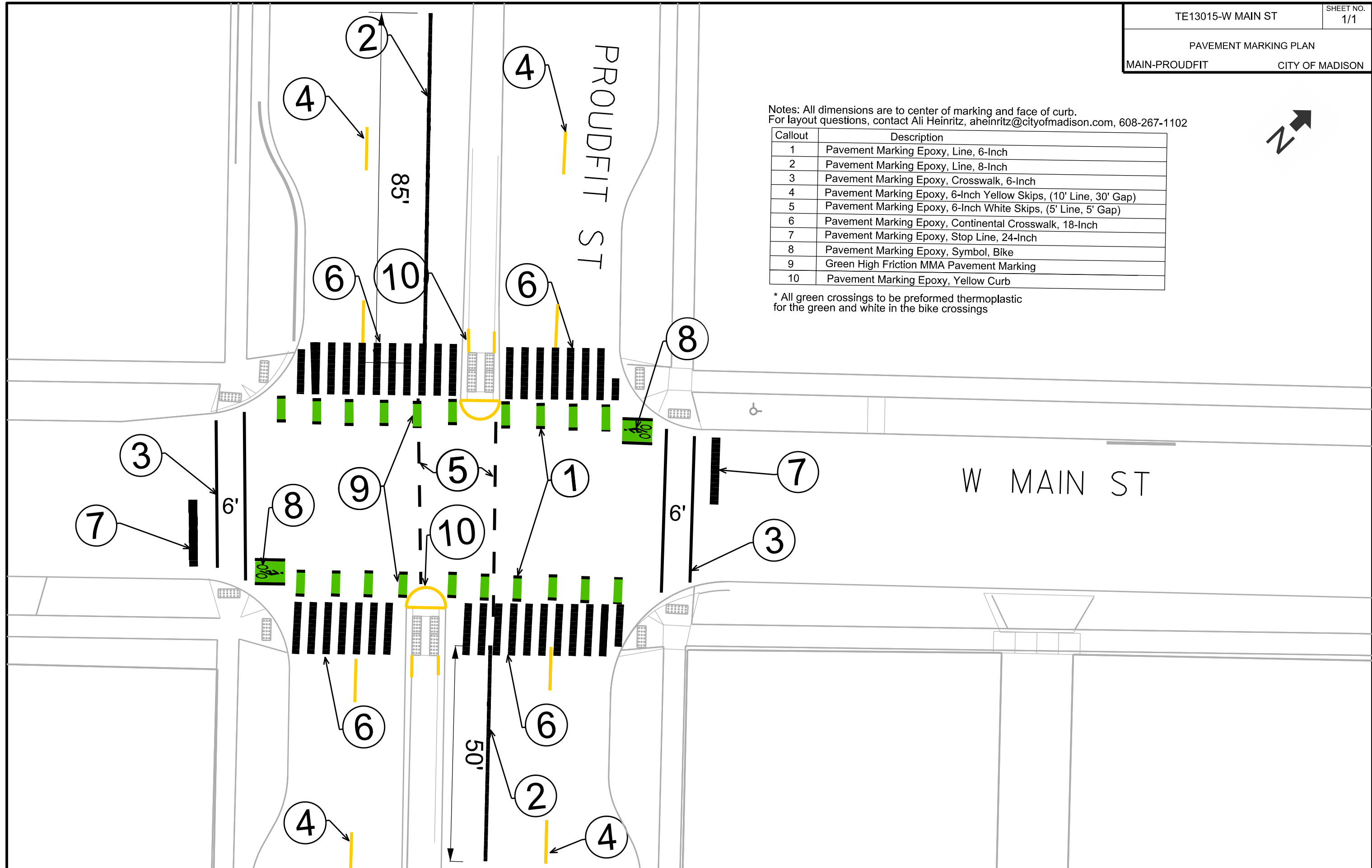

PLOT SCALE:

PLOT NAME:

REV. DATE:

ORIGINATOR: CITY OF MADISON, TRAFFIC ENG. DIV.

SCALE 1" = 20'

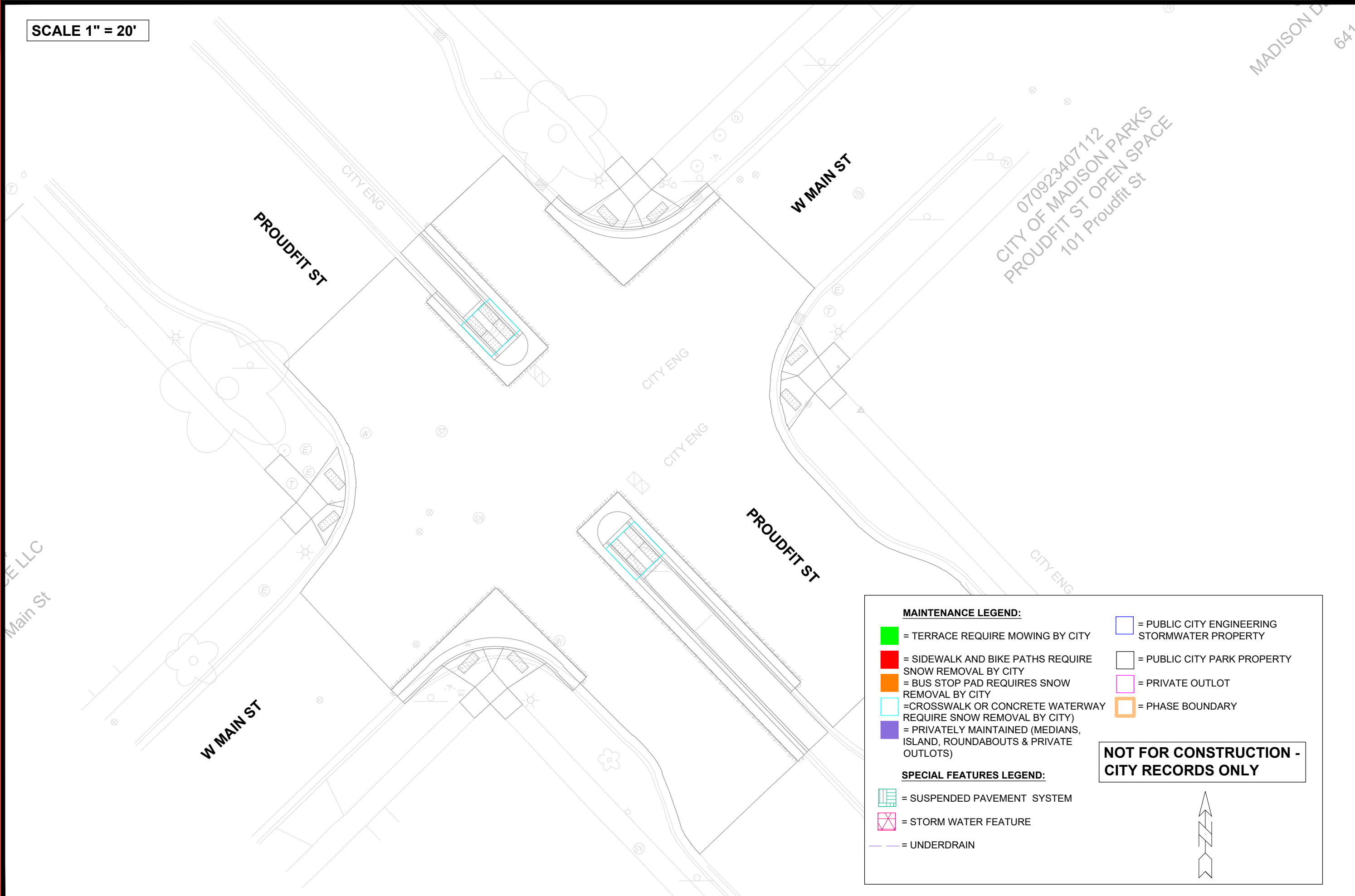

MAINTENANCE LEGEND:

- = TERRACE REQUIRE MOWING BY CITY
- = SIDEWALK AND BIKE PATHS REQUIRE SNOW REMOVAL BY CITY
- = BUS STOP PAD REQUIRES SNOW REMOVAL BY CITY
- = CROSSWALK OR CONCRETE WATERWAY REQUIRE SNOW REMOVAL BY CITY
- = PRIVATELY MAINTAINED (MEDIANS, ISLAND, ROUNDABOUTS & PRIVATE OUTLOTS)
- = PUBLIC CITY ENGINEERING STORMWATER PROPERTY
- = PUBLIC CITY PARK PROPERTY
- = PRIVATE OUTLOT
- = PHASE BOUNDARY

SPECIAL FEATURES LEGEND:

- = SUSPENDED PAVEMENT SYSTEM
- = STORM WATER FEATURE
- = UNDERDRAIN

NOT FOR CONSTRUCTION - CITY RECORDS ONLY



070923407112
 CITY OF MADISON PARKS
 PROUDFIT ST OPEN SPACE
 101 Proudfit St

MARK	REVISION	DATE	BY

13015
 MADISON, WI
 CONTRACT NO: 8721

MAINTENANCE MAP
 W MAIN ST BIKE BOULEVARD
 M:\DESIGN\Projects\13015\CAD\Streets\13015EN-Maintenance.dwg



13015
 MN-1